

TUBE CONNECTORS

RK15

Tube connector in PA6 with a steel core.

2-way connection for round tubes.



STOCK COLORS

Black

Additional RAL or custom colors on demand

ADDITIONAL INFO

Material: Thermoplastic

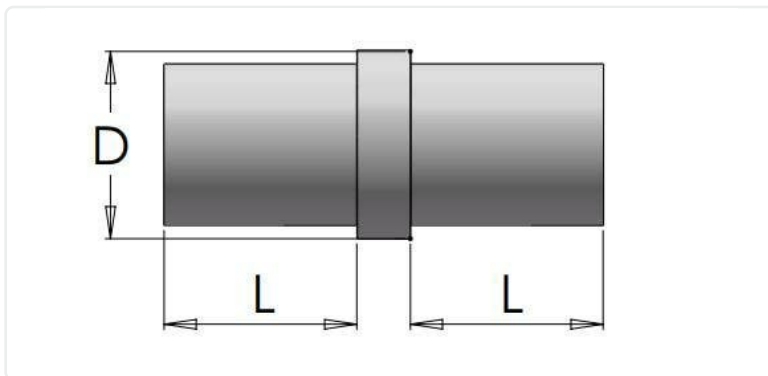

Article number	Material fasteners	Color	D	L	Tube external diameter	Tube thickness
RK15-901-16X1	-	Black	16	37.5	16	1.0
RK15-901-18X1,5	-	Black	18	36	18	1.5
RK15-901-19X1	-	Black	19	43	19	1.0
RK15-901-20X1,1	-	Black	20	36	20	1.1
RK15-901-20X1,5	-	Black	20	37	20	1.5
RK15-901-22X1	-	Black	22	36	22	1.0
RK15-901-22X1,5	-	Black	22	40	22	1.5
RK15-901-25X1,5	-	Black	25	38	25	1.5
RK15-901-26,9X1,5	-	Black	26.9	-	26.9	1.5

Article number	Material fasteners	Color	D	L	Tube external diameter	Tube thickness
RK15-901-26,9X2	-	Black	26.9	-	26.9	2.0
RK15-901-26,9X2,6	-	Black	26.9	-	26.9	2.6
RK15-901-28X1,5	-	Black	28	-	28	1.5
RK15-901-28X2	-	Black	28	50	28	2.0
RK15-901-30X1,5	-	Black	30	-	30	1.5
RK15-901-30X2	-	Black	30	-	30	2.0
RK15-901-32X1,5	-	Black	32	50	32	1.5
RK15-901-32X2,5	-	Black	32	50	32	2.5
RK15-901-34X2	-	Black	34	50	34	2.0
RK15-901-35X1,2	-	Black	35	50	35	1.2
RK15-901-35X1,5	-	Black	35	50	35	1.5
RK15-901-35X2	-	Black	35	-	35	2.0
RK15-901-36X2	-	Black	36	-	36	2.0
RK15-901-40X1,5	-	Black	40	60	40	1.5
RK15-901-40X2	-	Black	40	-	40	2.0
RK15-901-40X3	-	Black	40	-	40	3.0
RK15-901-48X2	-	Black	48	47	48	2.0
RK15-901-48X4	-	Black	48	47	48	4.0
RK15-901-50X1,5	-	Black	50	47	50	1.5
RK15-901-50X2	-	Black	50	48	50	2.0
RK15-901-60X2	-	Black	60	45	60	2.0
RK15-901-60X4	-	Black	60	45	60	4.0