

TUBE CONNECTORS

RK49

Tube connector in PA6 with a steel core and inner thread.

4-way connection (Cross-shaped) for square tubes.



STOCK COLORS

Black

Additional RAL or custom colors on demand

ADDITIONAL INFO

Material: Thermoplastic

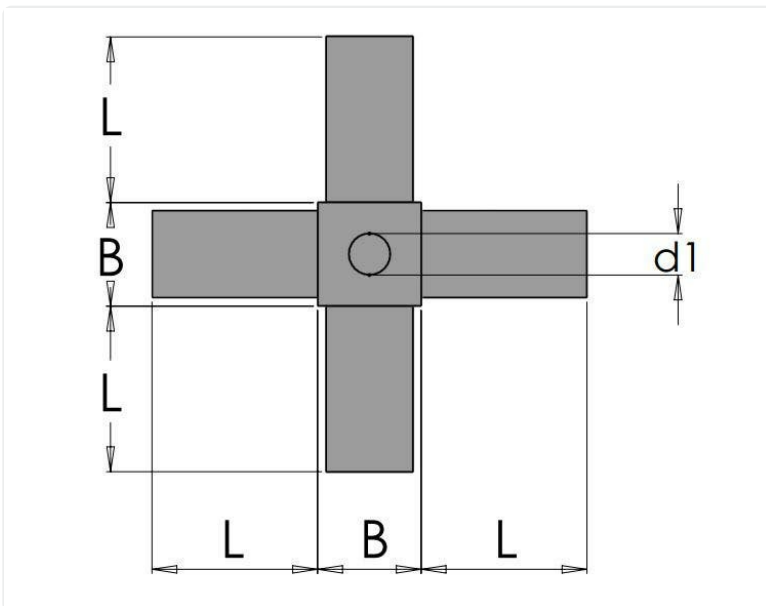

Article number	Material fasteners	Color	B	L	Tube external diameter	Tube thickness
RK49-901-25X25X1M8	-	Black	25	54	25X25	1.5
RK49-901-25X25X1M10	-	Black	25	54	25X25	1.5